

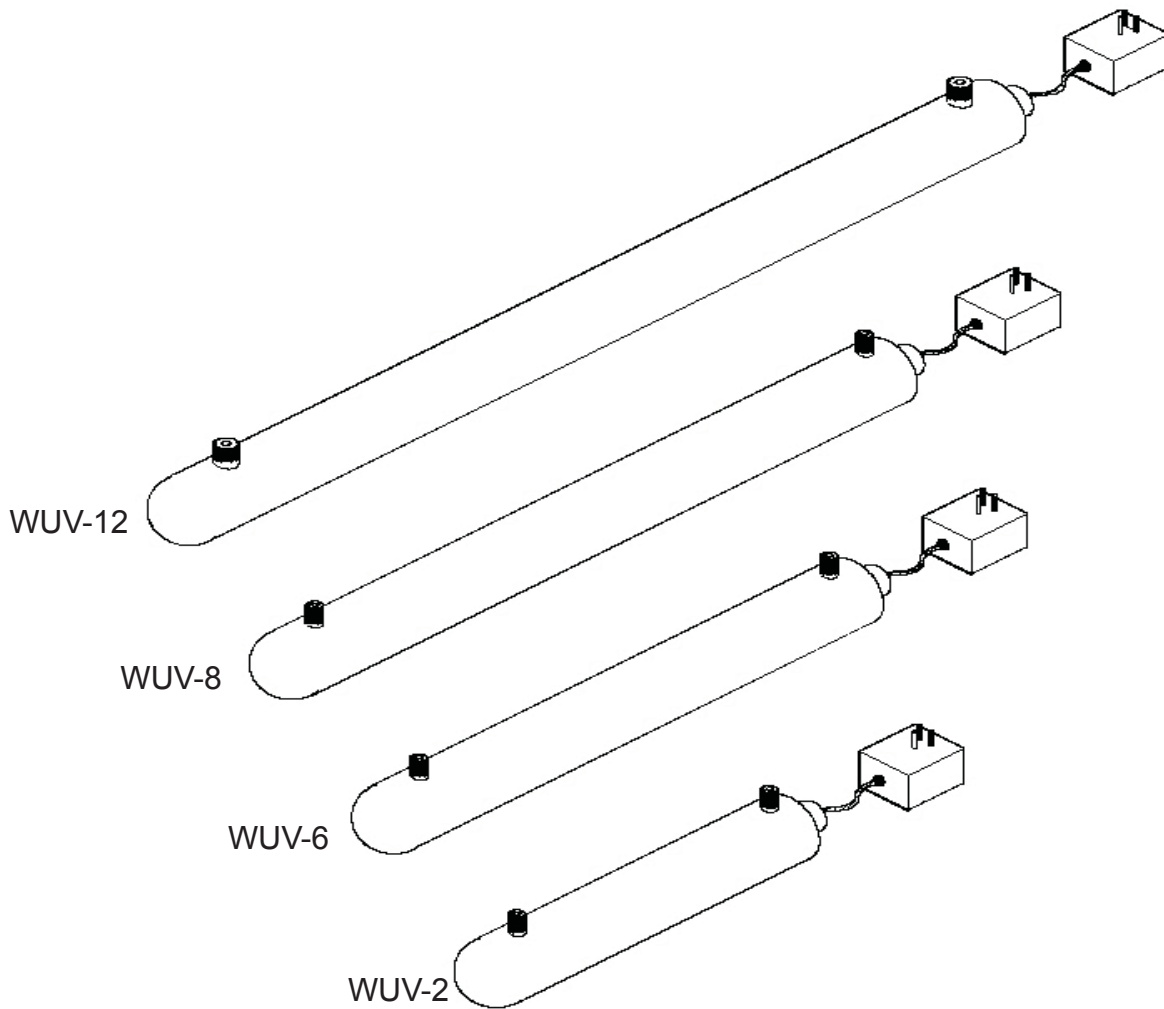

INSTALLING, OPERATING, AND MAINTENANCE
MODEL
WUV-2,6,8,12



Please read these instructions completely before operating this unit and retain it for future reference.

SPECIFICATIONS

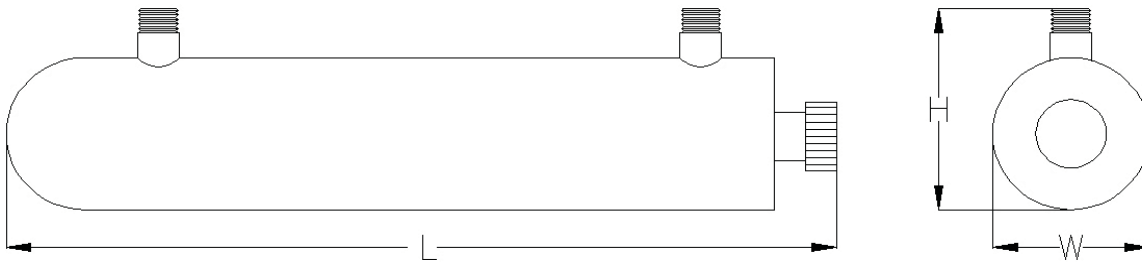

Notes: Line cord and lamp lead wire omitted for clarity.

| MODEL | FLOW RATE (gpm) | PIPE SIZE | DIMENSIONS (LxWxH) | ELECTRICAL |
|-----------|-----------------|-----------|-----------------------|-------------------|
| WUV2-110 | 2 | 1/2" MNPT | 18"x6"x5 3/8" | 110-130V/ 50-60Hz |
| WUV2-230 | 2 | 1/2" MNPT | 18"x6"x5 3/8" | 200-250V/ 50-60Hz |
| WUV6-110 | 6 | 3/4" MNPT | 25 1/2"x6"x5 3/8" | 110-130V/ 50-60Hz |
| WUV6-230 | 6 | 3/4" MNPT | 25 1/2"x6"x5 3/8" | 200-250V/ 50-60Hz |
| WUV8-110 | 8 | 3/4" MNPT | 32"x8 1/4"x3 3/4" | 110-130V/ 50-60Hz |
| WUV8-230 | 8 | 3/4" MNPT | 32"x8 1/4"x3 3/4" | 200-250V/ 50-60Hz |
| WUV12-110 | 12 | 1" MNPT | 41 1/2"x8 1/4"x3 3/4" | 110-130V/ 50-60Hz |
| WUV12-230 | 12 | 1" MNPT | 41 1/2"x8 1/4"x3 3/4" | 200-250V/ 50-60Hz |

(TYPICAL) Installation:

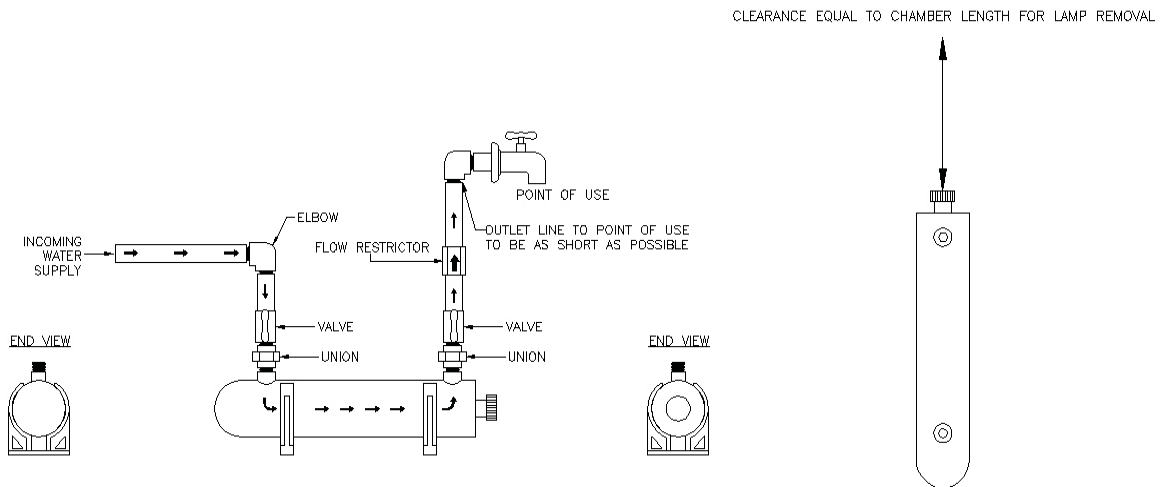

Notes:

1. Install sterilizer equipment in a readily accessible and well lit location to facilitate inspection and maintenance.
2. Inspect for hidden electrical wiring or plumbing prior to drilling holes.
3. Attach mounting clips to the wall.
4. Insert chamber through mounting clips.
5. Connect to plumbing.
6. Install quartz sleeve and lamp.

Note: Avoid touching the sides of the quartz sleeve and lamp, handle by the ends only.

- a. Remove the retainer nut.
 - b. Slide the quartz sleeve into the chamber - closed end first.
 - c. Slide the O-ring over the open end of the quartz sleeve.
 - d. Tighten the retainer nut hand tight.
 - e. Slide the lamp into the quartz sleeve.
 - f. Connect the lamp to the plug in transformer.
 - g. Cover the lamp connection with the vinyl cap.
7. Turn on the water and inspect for leaks. Repair if necessary.
 - 8a. **(For 110 Volts Units)** Plug the transformer into an electrical outlet. An electrical outlet protected by a Ground Fault Interrupt (GFI) circuit is recommended.
 - b. **(For 220 Volts Units)** Obtain the appropriate plug for your type of receptical and attach it to the end of the power cord and plug it in.

REPLACING UV LAMP AND SERVICING UV SYSTEM

Note: Avoid touching the sides of the quartz sleeve and lamp, handle by the ends only.

- Step 1** Disconnect power.
- Step 2** Turn water off and open valve down stream of system to relieve pressure.
- Step 3** Remove vinyl cap and unscrew the nut.
- Step 4** Carefully withdraw lamp approximately 2 inches from chamber.
- Step 5** While holding lamp end carefully remove lamp socket on end now exposed.
- Step 6** Carefully withdraw lamp from chamber.
- Step 7** Carefully remove O-ring from the end of quartz sleeve.
- Step 8** Carefully remove quartz sleeve.
- Step 9** To reinstall follow Steps 8 through 1 in reverse.

MAINTENANCE SUGGESTION:

To operate the sterilizer properly and attain its maximum efficiency that the user need to do some maintenance job as below.

1. Quartz sleeve cleaning or replacement:
 - a) Quartz sleeve is to be cleaned every 6-12 months, clean with glass cleaner.
 - b) Quartz sleeve is to be replaced every 24 months.
2. UV lamp replacement is recommended every 8000-9000 hours of operation (approx. 12 months of continuous service).

CAUTION: Ultraviolet lamp and quartz sleeve are easily damaged. Pay attention when removing or replacing lamp and quartz sleeve.

ASSEMBLY:

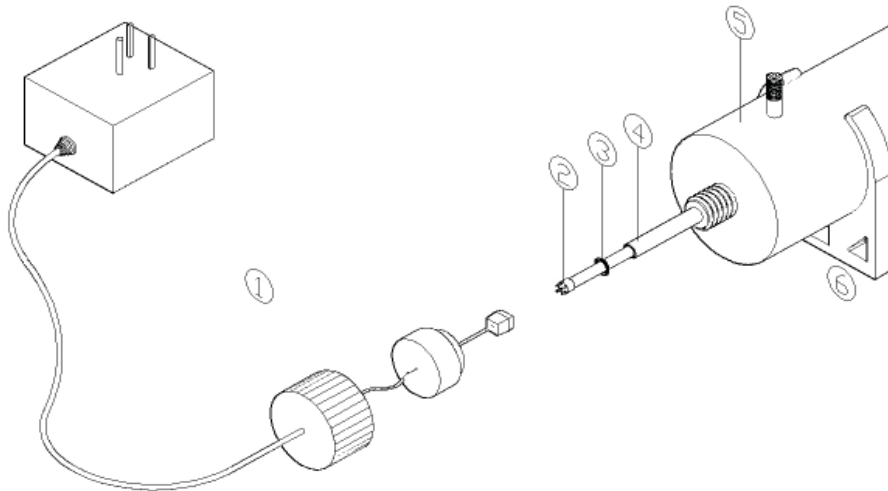

WARNING: Germicidal ultraviolet rays are harmful to eyes and skin.

| ITEM | DESCRIPTION | PART NO. |
|------|-----------------------------|---|
| 1 | BALLAST ASSEMBLY | WUVBALLAST2,6,8,12(AVAILABLE IN 110V OR 230V) |
| 2 | GERMICIDAL ULTRAVIOLET LAMP | WUVLAMP2,6,8,12 |
| 3 | RUBBER O-RING | T1200-0116 |
| 4 | QUARTZ SLEEVE | WUVQS2,6,8,12 |
| 5 | CHAMBER | N/A |
| 6 | MOUNTING CLIP | C2500W |